

DE Contents DE Inhalt FR Contenu NL Inhoud FI Sisältö  
 UK Indhold IT Contenuto ES Contenido PT Conteúdo  
 GR Περιεχόμενα SE Innehåll

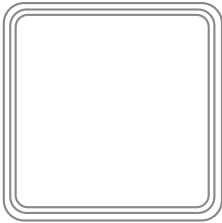

x1



x1



x1



x1



x2



x2



x2

CR2032



x1

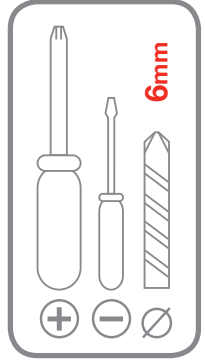

DE Getting started DE Erste Schritte FR Démarrage NL Aan de slag FI Aloitusopas UK Kom i gang  
 IT Operazioni preliminari ES Para empezar PT Para começar GR Προεργασία SE Kom igång



x1



x1

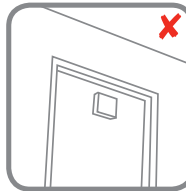

30mm

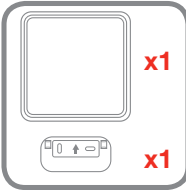
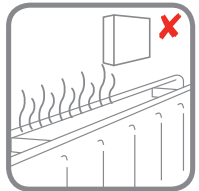

x1

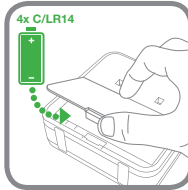

x1

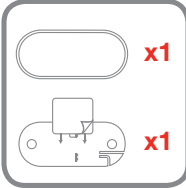
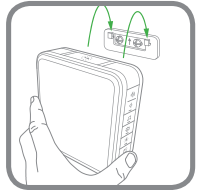
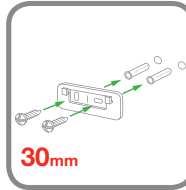

x1

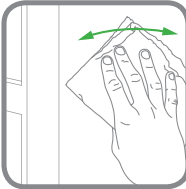
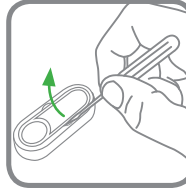
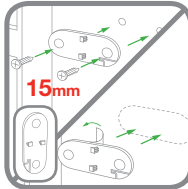

08 Optional features 05 Optionale Funktionen 07 Options disponibles 09 Optics  
 04 Valinnaiset ominaisuudet 06 Valgírle funkcioner 11 Funzionalità opzionali  
 03 Opciones disponibles 02 Funções opcionais 08 Προαιρετικές λειτουργίες, πρόσθετων  
 05 Mõjliga funktsioner

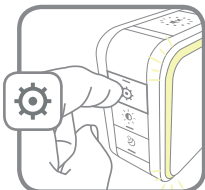
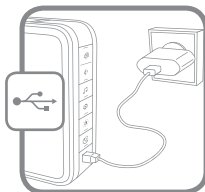
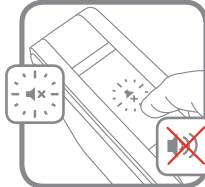
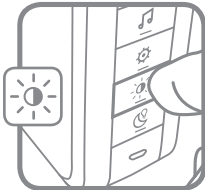

	Hello	Ding Dong	Westminster	Marimba	Piano	Bell	Telephone	Soft Alert
	•	•					•	•
	•	•	•	•			•	•
	•	•	•	•	•	•	•	•

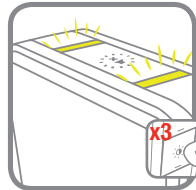
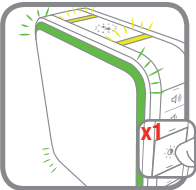

	<del></del>		<del></del>
	<del></del>		<del></del>

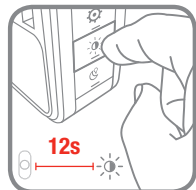

08 Linking 05 Einlernen  
 04 Programmation 09 Verknüpfung  
 07 Linkitáminn 06 Forbnde  
 11 Collegamento 05 Enlace 07 Pro-  
 gramação 08 Ουδέσση 05 Länkning



08 Trouble shooting 09 Fehlerbehebung 07 Dépannage 09 Probleemoplossing  
 04 Vianmääritys 06 Problemlösning 11 Risoluzione dei problemi 03 Solución de  
 problemas 02 Resolução de problemas 08 Αντιμετώπιση προβλημάτων 05 Felsökning

[livewell.honeywell.com](http://livewell.honeywell.com)



DE Contents **DE** Inhalt **FR** Contenu **IT** Inhoud  
**F** Sisältö **UK** Inhoud **IT** Contenuto  
**ES** Contenido **TR** İçerik **GR** Περιεχόμενα  
**SE** Innehåll



x1

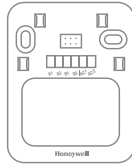

x1



x2



x2

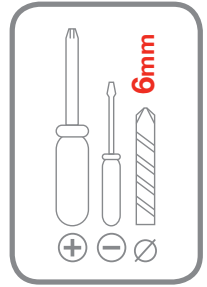

**DE** Getting started **DE** Erste Schritte **FR** Démarrage **IT** Aan de slag  
**F** Aloitusopas **UK** Kom i gang **IT** Operazioni preliminari **ES** Para empezar  
**TR** Para comenzar **GR** Πρώτα βήματα **SE** Kom igång

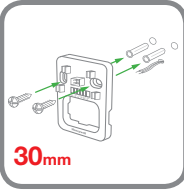
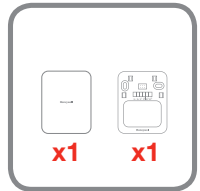
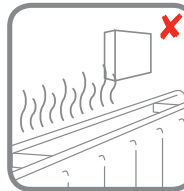
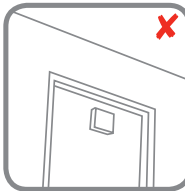
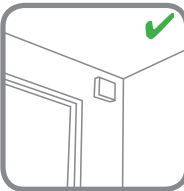

30mm

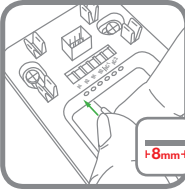

8mm

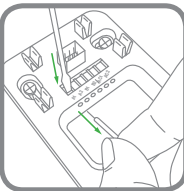
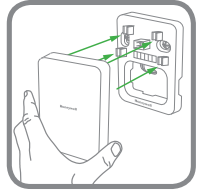
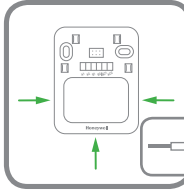

CR2032

- GB Wired push GB Verdrahteter Drucktaster FR Bouton poussoir M Bekabeide drukkноп
- FI Johdotettu painike M Kabelit tryk I Pulsante cablato S Pulsador cableado T Botão com fios
- GR Καλωδιωμένο ωατήριο S Trådbunden tryckknapp

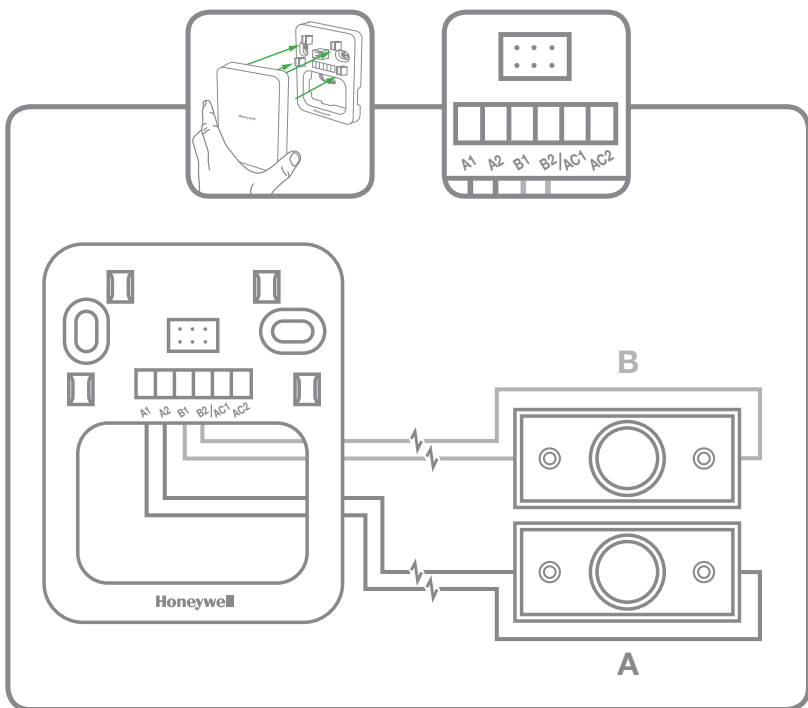
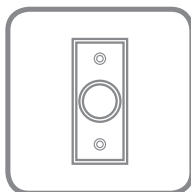

**GB** Wired illuminated push with transformer **DE** Verdrahteter Druckknopf mit Beleuchtung und Transformator **FR** Bouton poussoir éclairé avec transformateur  
**NL** Verlichte bekebelde drukknoop met transformator **F** Johdotettu valaistu painike muuntajalla **DK** Kabelbet belyst tryk med transformer  
**IT** Pulsante cablato illuminato con trasformatore **ES** Pulsador iluminado cableado con transformador **PT** Botão iluminado com fios com transformador  
**GR** Καλωδιωμένο φωτιστικό με μετασχηματιστή **SE** Trådbunden upplyst tryckknapp med transformator

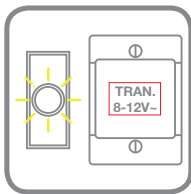

- GB** Always ensure the main supply is disconnected before installation, follow Transformer Instructions.
- DE** Immer daran denken, die Hauptversorgung vor der Installation abzuschalten. Dazu die Transformatoranweisungen befolgen.
- FR** Assurez-vous toujours que l'alimentation principale est déconnectée avant l'installation. Respectez les consignes concernant le transformateur.
- NL** Zorg er altijd voor dat de hoofdtoevoer afgesloten is voordat er met de installatie begonnen wordt, volg de instructies voor de transformator.
- F** Varmista aina, että päävirransyöttö on katkaistuna ennen asennusta, ja noudata muuntajan ohjeita.
- DK** Sørg altid for, at strømmen er afbrudt før installation. Følg Transformator instruktionerne.
- IT** Assicurarsi sempre che l'alimentazione principale sia scollegata prima di procedere con l'installazione. Seguire le istruzioni relative al trasformatore.
- ES** Asegúrese siempre de que el suministro eléctrico está desconectado antes de la instalación, siga las instrucciones del transformador.
- PT** Certifique-se sempre de que a fonte de alimentação principal é desligada antes da instalação e siga as instruções do transformador.
- GR** Να βεβαιώνετε πάντοτε ότι η κύρια παροχή είναι αποσυνδεδεμένη πριν από την εγκατάσταση, τηρείτε τις Οδηγίες για τον Μετασχηματιστή
- SE** Se alltid till att elnätet är bortkopplat innan installationen och följ transformatorns instruktioner.

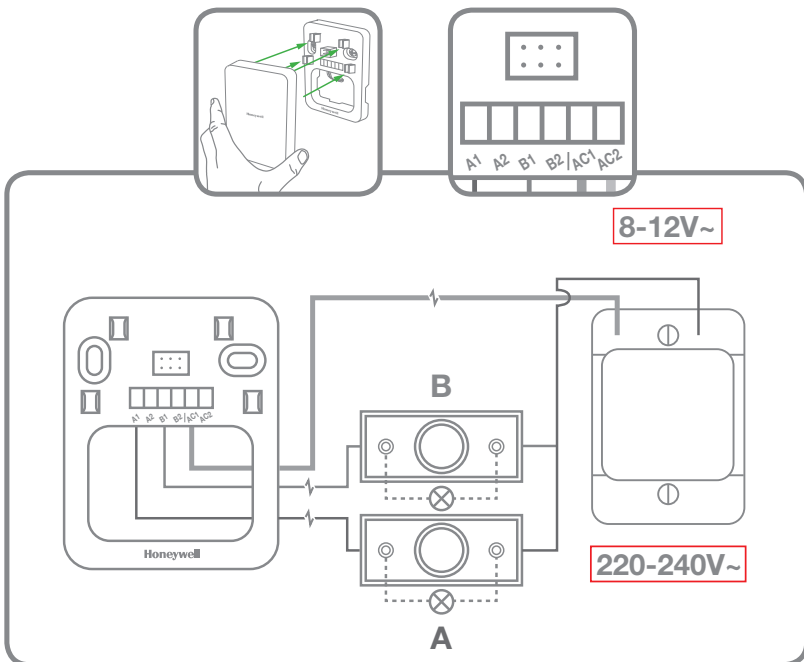

GB Linking DE Einlernen FR Programmation  
NL Verknüpfung FI Linkittäminen OK Forbinde  
IT Collegamento ES Enlace  
PT Programação GR Ουδέσση SE Länkning

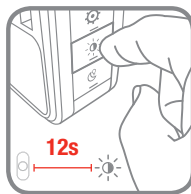
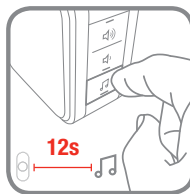
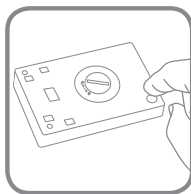
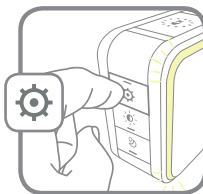

GB Trouble shooting DE Fehlerbehebung FR Dépannage NL Probleemoplossing  
FI Vianmääritys OK Problemlösning IT Risoluzione dei problemi ES Solución de  
problemas PT Resolução de problemas GR Αντιμετώπιση προβλημάτων SE Felsökning

[livewell.honeywell.com](http://livewell.honeywell.com)



32304375-004 Rev.A